

The floor plan shows a rectangular building layout with 18 numbered rooms. The rooms are arranged in two rows of nine. The top row rooms are numbered 1 to 10, and the bottom row rooms are numbered 18 to 11. The central area contains a staircase (UC) and a children's play area (RULLSTOL BARNVAGN). The entrance (Entré) is located on the left side, and the utility room (Utrymning) is on the right side. The plan includes various furniture and fixture symbols, such as desks, chairs, and toilets. Dimensions and structural details are also shown.

Room Number	Area (m²)
1	32,5
2	25
3	33
4	25
5	38
6	25
7	29
8	26
9	25
10	41
11	35
12	31,5
13	36
14	32
15	25
16	33
17	25
18	32,5

Other labels and dimensions include: "Bef ramp ca 11000", "6300", "2000", "6000", "2000", "Entré", "Postboxar", "UC", "RULLSTOL BARNVAGN", "Utrymning", "Takhöjd minst 1900 hit", and "HÄNVISNINGAR".

Plan 1 tr BOA se respektive lgh

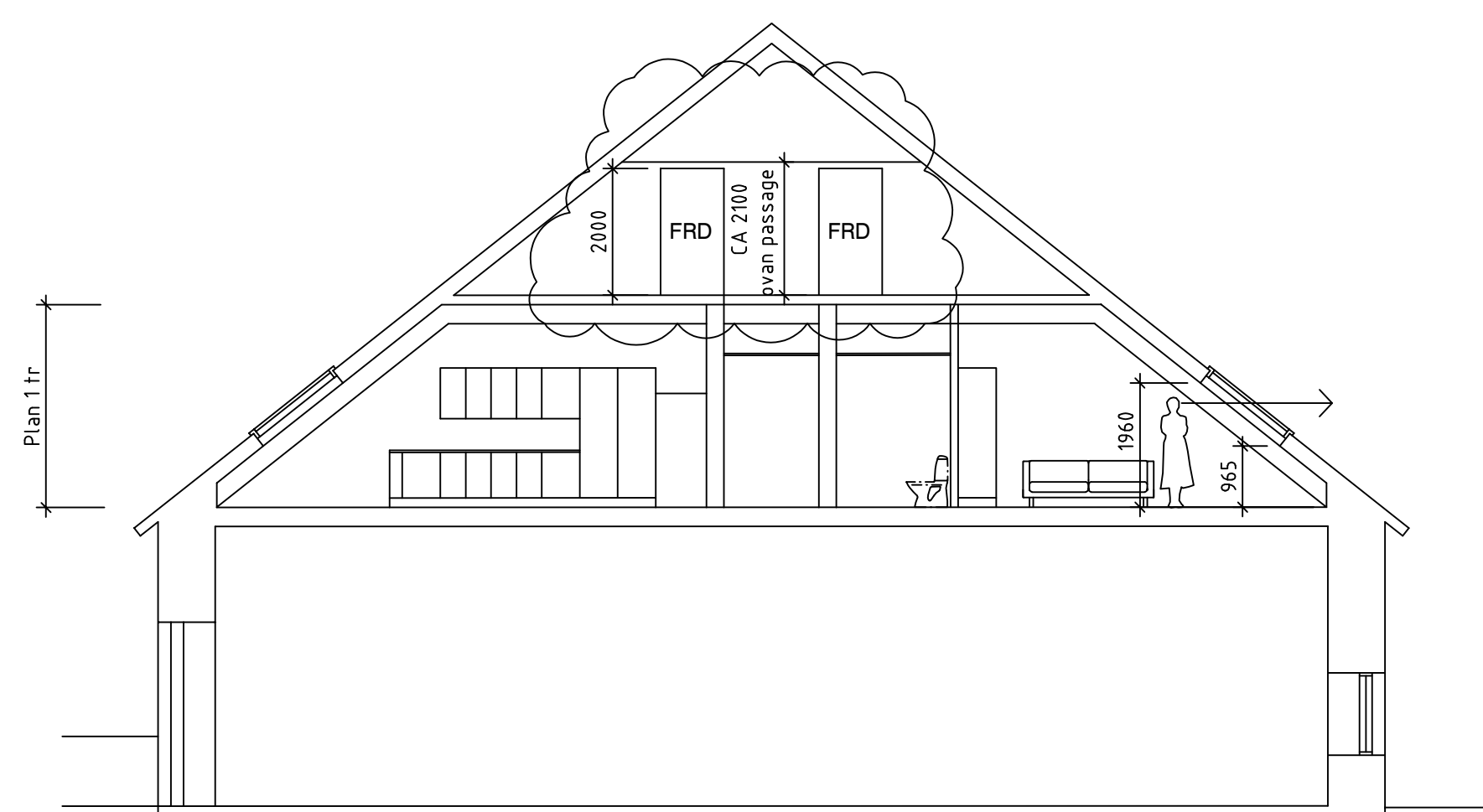

Sektion

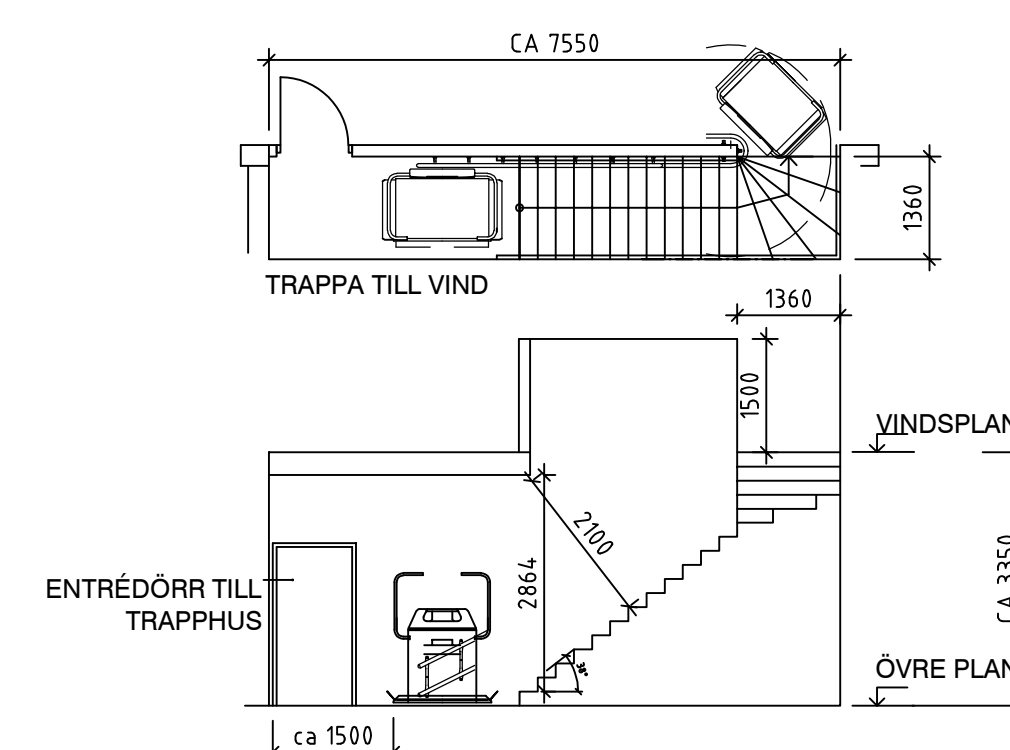

Plan/sektion trapphus till vind

B		KOMPLETTERING MÅTT VIND	VL	250312
A		JUSTERING TRAPPHUS FÖR	HISS VL	250218
BET	ANT	ÄNDRINGEN AVSER	SIGN	DATUM

LAFLAMME ARKITEKTER

BYGGLOVSHANDLING

UPPDRAK NR	RTID/KONSTR AV	HANDLÄGGARE
DATUM	VLE	VLE
2024-12-13	ANSVARIG Rickard Nyman	
PRÄSTKAMMAREN 2, HÄSSELBY		
ÖVRE PLAN		
0 METER		
HELSKALA	HALVSKALA	NUMMER
1:100	1:200	A-40.1-02
		B