

Architectural floor plan of a building with 18 numbered rooms. The plan includes a ramp on the left, an entrance area with a postbox, and various rooms with furniture and fixtures. Dimensions and area measurements are provided for each room. The building is flanked by hatched areas representing terrain. Arrows indicate the direction of traffic flow.

Room Details:

Room Number	Area (m²)	Key Features
1	35	ST, L, G, G, WC/D, TP, KF
2	25	WC/D, TP, KF
3	34	WC/D, TP, KF
4	25	WC/D, TP, KF
5	34	WC/D, TP, KF
6	25	WC/D, TP, KF
7	29	WC/D, TP, KF
8	26	WC/D, TP, KF
9	25	WC/D, TP, KF
10	41	WC/D, TP, KF
11	33	WC/D, TP, KF, TILLGÅNGSLUGA
12	33	WC/D, TP, KF, RULLSTOL BARNVAGN
13	32	WC/D, TP, KF
14	31	WC/D, TP, KF
15	25	WC/D, TP, KF
16	34	WC/D, TP, KF
17	25	WC/D, TP, KF
18	35	WC/D, TP, KF

Other Features:

- Entré:** Entrance area with Postboxar.
- UC:** Central utility area.
- Takhöjd minst 1900 hit:** Ceiling height specification at two locations.
- HÄNVISNINGAR:** Reference notes at the bottom right.

BOA se respektive lgh

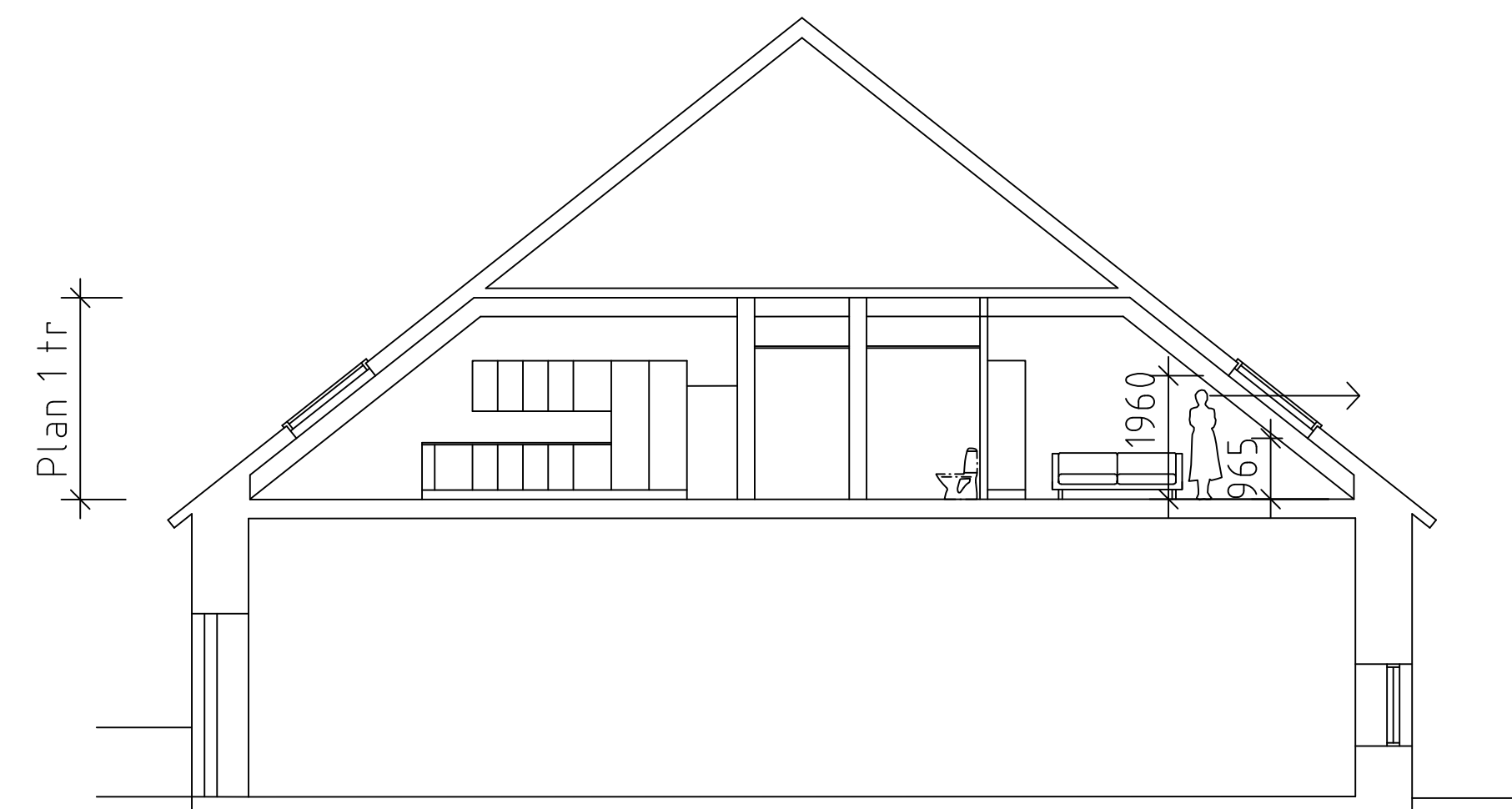

Sektion

BET	ANT	ÄNDRINGEN AVSER	SIGN	DATUM
LAFLAMME ARKITEKTER				
BYGGLOVSHANDLING				
UPPDRAG NR		RITAD/KONSTR AV	HANDLÄGGARE	
		VLE	VLE	
DATUM		ANSVARIG		
2024-12-13		Rickard Nyman		
PRÄSTKAMMAREN 2, HÄSSELBY				
ÖVRE PLAN				
0 METER				
HELSKALA	HALVSKALA	NUMMER	BET	
1:100	1:200	A-40.1-02		