

Färg: Grön, Kod: NCS 7010-G30Y

KA2VM0003 Ellevio AB

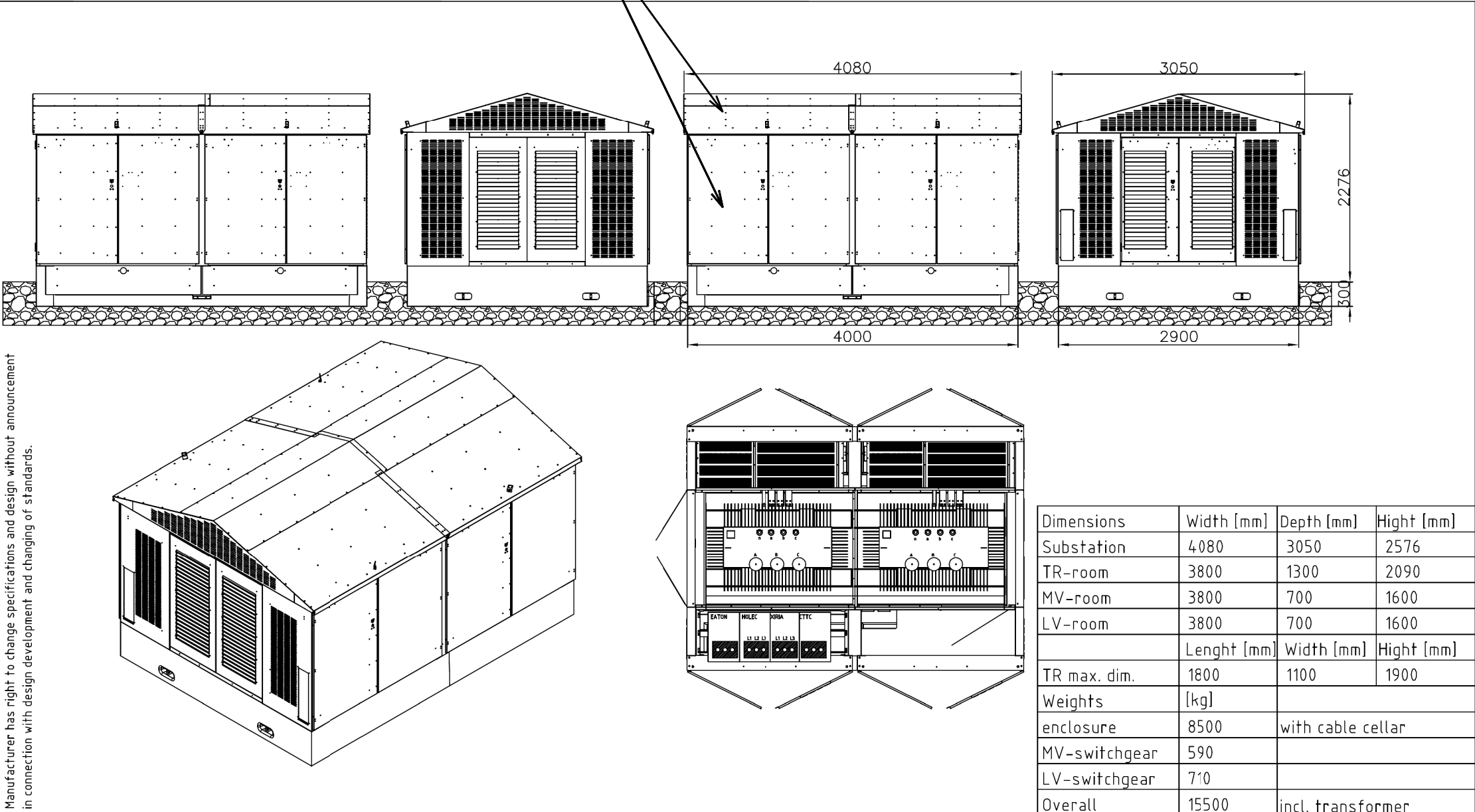

Manufacturer has right to change specifications and design without announcement in connection with design development and changing of standards.

Dimensions	Width [mm]	Depth [mm]	Hight [mm]
Substation	4080	3050	2576
TR-room	3800	1300	2090
MV-room	3800	700	1600
LV-room	3800	700	1600
	Lenght [mm]	Width [mm]	Hight [mm]
TR max. dim.	1800	1100	1900
Weights	[kg]		
enclosure	8500	with cable cellar	
MV-switchgear	590		
LV-switchgear	710		
Overall	15500	incl. transformer	

A			Object	Date		Calculation nr.	Sheet size
B			Ellevio AB	10.11.2015		KA2VM0003	DIN A4
C			Substation type 015 CTTC	Designer	E.A.	Offer nr.	Scale
D			10...22/0,4 kV				1:60
E			Drawing	Check	T.L.	Work nr.	Stage
	Change	Date	Name			Drawing nr.	Sheet/sheets
			Compact sheet metal substation with concrete foundation			KA2VM0003_L1	1/ 1
			max. 2x800 kVA				
			General drawing				



Harju Elekter Elektrotehnika AS
Tel +372 6 747 449
faks +372 6 747 441

Paldiski mnt. 31
76606 Keila
mail@he.ee

REV	ANT	ÄNDRINGEN AVSER	DATUM	SIGN

BYGGLOVSANSÖKAN



DATUM	PROJEKTR	RITAD/KONSTR. AV
2023-11-17	SA74949	Shubair Abdulrada
GRANSKAD AV	PROJEKTLEDARE	
Peter Marcateus Asklund	Jimmy Sagar	

Årsta 1:1 del av
Uppköparvägen 2:1
015 Plan & Fasad

SKALA	RITINGS NR	REV
- (A3)	73837-2-B04	