

NOTES AND LEGEND

ALL DIMENSIONS GIVEN IN MM.
ALL DIMENSIONS TO BE VERIFIED IN FIELD PRIOR TO CONSTRUCTION.
ALL DEVIATIONS MADE FROM THIS DRAWING SHOULD BE DISCUSSED WITH THE PROJECT RESPONSIBLE.

NOTE: CHECK PROJECT - OR INTERIOR CATALOGUE AS PRODUCT NUMBERS ON DRAWING MIGHT DIFFER ON ORDER.

POWER KEY:

Installation requiring power & IT: Screens.
Number of screens and power plates used, elevation.
Local/Global BT team to support with suitable hardware installations (media player/box to play content).
No visible cables or sockets or other hardware than screen.

Socket to be able to support DJ booth

13amp socket to position indicated. Use brushed finish st. steel cover plates. Mount at 250mm AFL.
All other visible sockets in store to have same finish. Refer to SDC450.

All existing power outlets to be kept, cover plates painted to match surrounding wall.

Existing sound system updated (if not already in place) to play separate music on ground floor and in basement.

NOTE:
All power according to H&M GBS.
The symbols above define additional Monk Power Contractor to liaise with IT to ensure correct specification and quantities are installed.

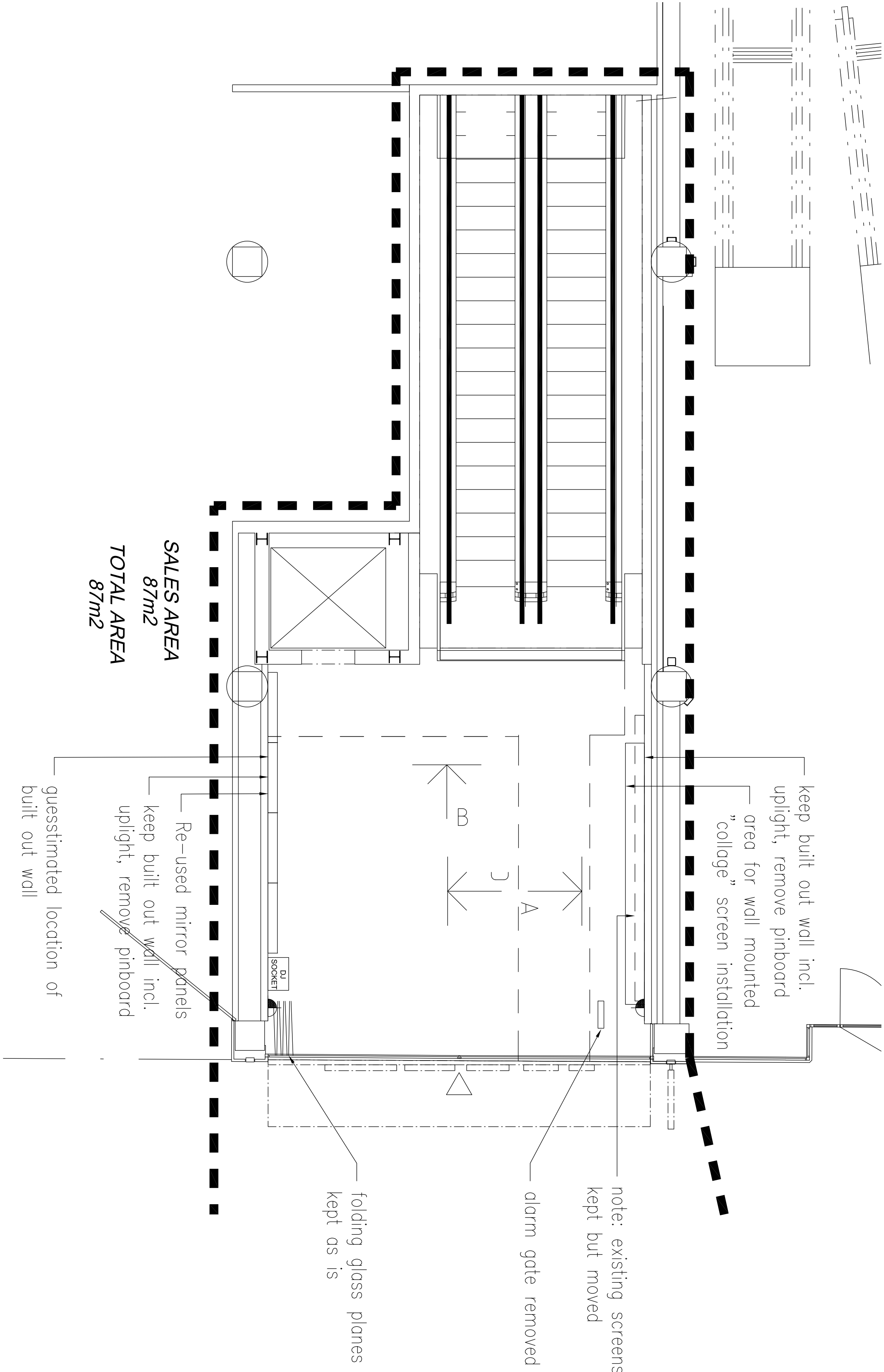

ALL MEASUREMENTS TO BE
CHECKED ON SITE

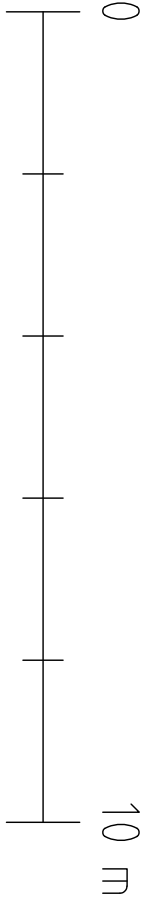

A	Tender drawings			JM	2022-03-25		
REV	DESCRIPTION	SIGN	DATE				
CLASS	SE0639 Monki						
Drothingatan, new							
store 2022							
MONKI							
H & M Hennes & Mauritz GBC AB SE-105 47 Stockholm							
Interior Department							
Tel: +46 8 7965500							
STORE CODE	ENTRY ID						
SE0639	PS700L						
CLASS	PROJECT MANAGER						
Monki	Badhr Gaouar						
DATE	STORE PLANNER						
2022-03-25	Julia Madas						
Layout		Basement					
New Opening							
OPENING REASON	PRODUCT LIST						
2022-09	MONKI DREAM MONI EVERY (423827)						
SCALE	DRAWING NAME	REV					
1:50@A1	136:091	A					

This drawing is the property of H&M Group. Copyright is reserved.

By title and the drawing is issued on the condition that it is not copied, reproduced, or used in any way without the written permission of H&M Group.

SE0639-2022-09-25-00

This drawing is the property of H&M Group. Copyright is reserved by H&M and the drawing is issued on the condition that it is not copied, reproduced, modified, or otherwise used without the written consent of H&M Group.